

DIMENSIONS- INCHES & [mm]

TOLERANCES: ±0.005 [0.12] UNLESS OTHERWISE STATED

REV.	ECO/DDC	DESCRIPTION	DATE	DRAFT	CHECK	APV'D
A	07939	RELEASED FOR PRODUCTION.	07-03-01	S.N.	L.B.O.	D.C.

CAPACITY LBS [KG]	H1	H2	∅D1	∅D2	BOLT 	TORQUE
440 [200]	0.50 [12.7]	0.25 [6.3]	0.405±0.003 [10.26±.06]	0.712±0.003 [18.06±.06]	.500-13 UNC X 1.75 L [M12 X 1.75, 45.0 L] GRADE 5	65 FT LBS [90Nm]
1.1k [500]	0.63 [15.9]	0.43 [10.9]	0.405±0.003 [10.26±.06]			65 FT LBS [90Nm]
2.2k [1000]	0.75 [19.1]	0.24 [6.0]	0.562±0.003 [14.26±.06]			75 FT LBS [100Nm]
4.4k [2000]	1.00 [25.4]	0.26 [6.5]	0.688±0.003 [17.46±0.06]	0.909±0.003 [23.06±0.06]	.500-13 UNC X 2.00 L [M12 X 1.75, 50.0 L] GRADE 5	90 FT LBS [125Nm]

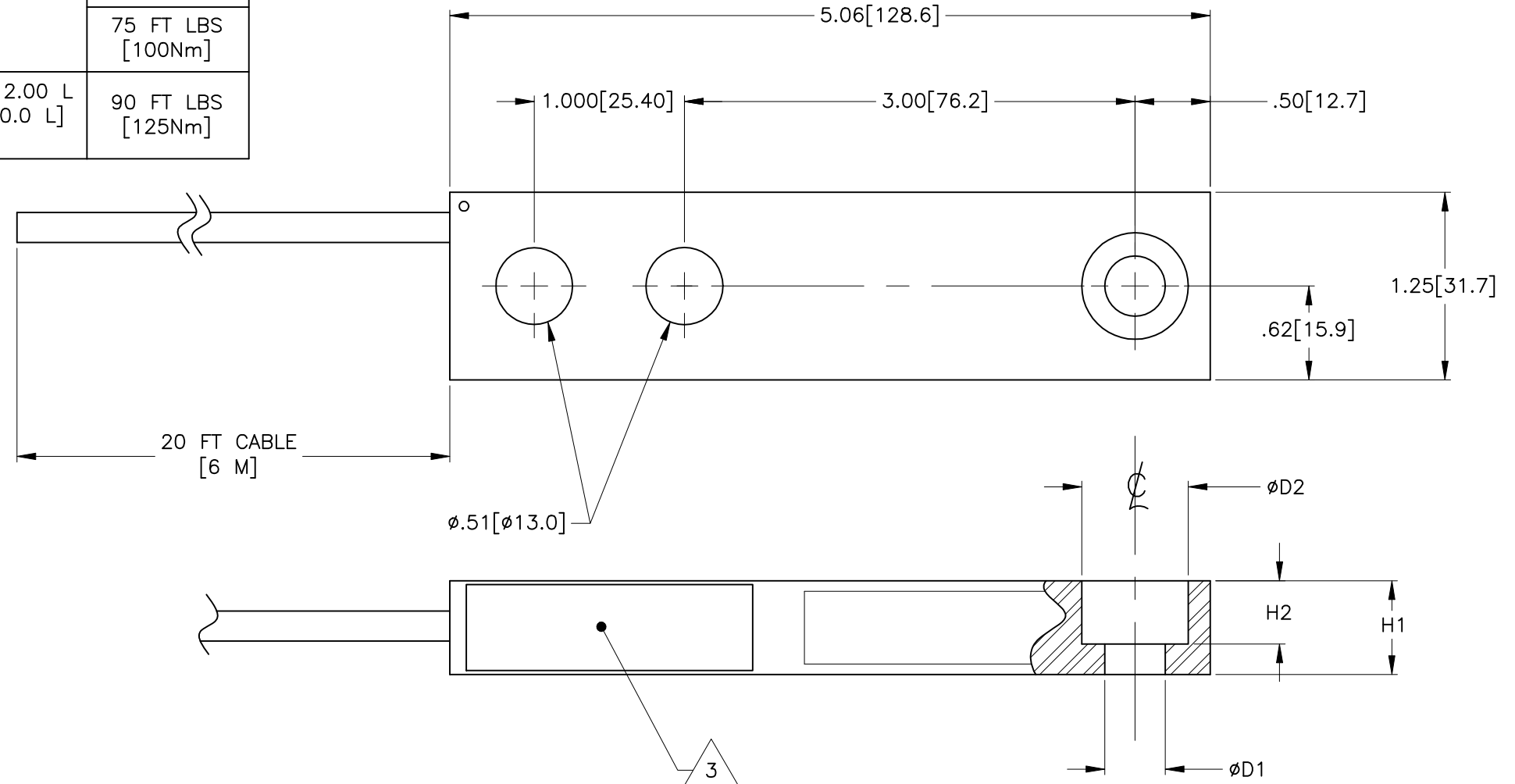

 USE 2 EACH TO MOUNT LOAD SENSOR.

7. LOAD SENSOR IS STAINLESS STEEL 17-4PH (1.4548).

6. CABLE IS 6 CONDUCTOR, SHIELDED AND 20 FT. IN LENGTH. CABLE SHIELD IS FLOATING.

5. C2 WIRE COLOR CODE FLAG LABEL, PN 0530-0594, TO BE LOCATED APPROX. 10 IN. FROM END OF CABLE.

EXCITATION +	RED
EXCITATION -	BLACK
SIGNAL +	GREEN
SIGNAL -	WHITE
C2 +	GRAY
C2 -	VIOLET
SHIELD	YELLOW

4. CABLE WIRE ENDS ARE STRIPPED BACK 0.5 IN. AND TINNED. CABLE JACKET IS STRIPPED BACK APPROX. 6 IN.

 LOCATION OF MODEL/SERIAL NUMBER LABEL. PN 0530-0614-XX.

2. THIS DRAWING IS SUBJECT TO CHANGE WITHOUT NOTICE.

1. RATED OUTPUT: 2mV/V ±0.1%.

NOTES: UNLESS OTHERWISE SPECIFIED

PROPRIETARY NOTICE
ALL DATA AND INFORMATION CONTAINED IN OR DISCLOSED BY THIS DOCUMENT IS CONFIDENTIAL AND PROPRIETARY INFORMATION OF HARDY INSTRUMENTS INC. AND ALL RIGHTS THEREIN ARE EXPRESSLY RESERVED. BY ACCEPTING THIS MATERIAL THE RECIPIENT AGREES THAT THIS MATERIAL AND THE INFORMATION CONTAINED THEREIN IS HELD IN CONFIDENCE AND IN TRUST AND SHALL NOT BE USED, COPIED, REPRODUCED IN WHOLE OR IN PART, NOR ITS CONTENTS REVEALED IN ANY MANNER TO OTHERS, EXCEPT TO MEET THE SPECIFIC PURPOSE FOR WHICH IT WAS DELIVERED.

CAPACITY LBS [KG]	MODEL NUMBER	PART NUMBER
440 [200]	HI SB02-440	0554-0022-04
1.1K [500]	HI SB02-1.1K	0554-0022-01
2.2K [1000]	HI SB02-2.2K	0554-0022-02
4.4K [2000]	HI SB02-4.4K	0554-0022-03

0588-0090		OUTLINE DRAWING, LOAD SENSOR, HI SB02 SERIES			
ITEM	QTY	PART NUMBER	DESCRIPTION	COMMENTS	
PARTS LIST					
UNLESS OTHERWISE SPECIFIED DIMENSIONS ARE IN INCHES [MM]			CONTRACT NO.		
TOLERANCES ARE: DECIMALS: .XX AND .XXX = ±.005 [.12] ANGLES: N/A			APPROVALS		
MATERIAL			DRAWN S. NAVARRO	DATE 01-18-01	
FINISH			CHECKED V. CHULA	DATE 01-31-01	
DO NOT SCALE DRAWING			APPROVED D. CORNWELL	DATE 02-09-01	
			ISSUED K. Mc NULTY	DATE 02-13-01	
			PRODUCTION	DATE	
SIZE D 21316		FSCM 0588-0090		DRAWING NO. 0588-0090	
REV. A		FILE NAME: 588090A1.DWG		SCALE: NONE	
		SHEET 1 OF 1			



**OUTLINE DRAWING, LOAD
SENSOR, HI SB02 SERIES**